

REV	LOCATIONS	DESCRIPTION	DATE	REVISER	APPD
1	△	ADD DIM	13/AUG/15	KEVIN	CHERRY
2	△	1: Size changes 2: ADD DIM	08/NOV/21	MATT	CHERRY
3	△	Add marking code	13/Jan/25	NICK	LEO

SPECIFICATIONS

Electrical
 Current Rating: 3A AC(rms)/DC
 Voltage Rating: 250V AC(rms)/DC
 Contact Resistance: 30 mΩ Max
 Insulation Resistance: 1000 MΩ Min
 Withstanding Voltage: 500V AC r.m.s
 Temperature Range-Operating: -55°C~+105°C

Material and plating
 Housing: PBT UL 94V-0
 Contact: Copper Alloy/ Gold plated/
 Selective gold in contact area, tin on tail
 Shell: SPCC/ Nickel Plated

Ordering Information

FDB 78 05 - F0 D S X XX K6 K A
 1 2 3 4 5 6 7 8 9 10 11

1	Category	2	Circuits	3	Distinction No.	4	Type	5	Assembly Layout	6	Entry Angle
	FDB- D-SUB Connector		78-78 Circuits		05		F0-Female		D-DIP		S-180° Vertical
7	Plating	8	Thickness of Plating	9	Color-Resin	10	Packaging	11	Distinction Type		
	1-Gold Plated 3-Selective gold in contact area, tin on tail		00-Gold Flash 03-3μ" Custom Plate Available		K6-Black		K-Tray		A-A Type		

THIRD ANGLE PROJECTION	GENERAL TOLERANCES (UNLESS SPECIFIED)		APPROVE BY	DATE	PART NO.	ITEM NO.	 Building Technology Cornerstone
	X.±0.12(0.30)	X.±5°	FRANK	28/AUG/13	FDB7805-FODSXXXK6KA	FDB7805	
DESIGN UNITS Inch (metric)	X.X±.008(0.20)	.X'±2'	CHECKED BY	DATE	TITLE		REV 3 SHEET NO. 1/1
SCALE 5:1	X.XX±.006(0.15)	.XX'±1'	CHERRY	28/AUG/13	D-SUB connector 78 Circuits 180° Vertical Female		
SIZE A4	X.XXX±.004(0.10)	.XX'±0.5'	DRAWN BY	DATE	THIS DRAWING CONTAINS INFORMATION THAT IS PROPRIETARY TO TXGA INDUSTRIAL ELECTRONICS(S.Z)CO.,LTD AND SHOULD NOT BE USED WITHOUT WRITTEN PERMISSION		
			KEVIN	28/AUG/13			

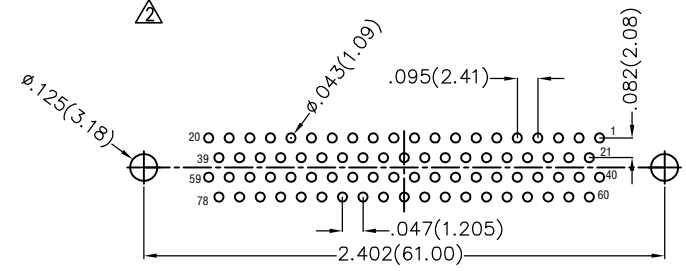
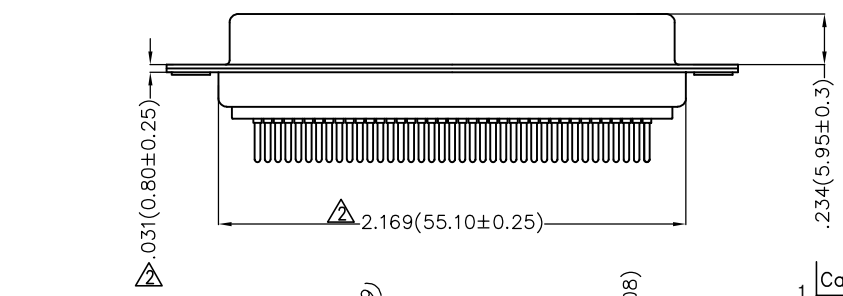
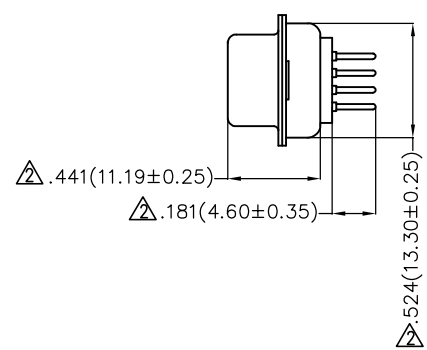
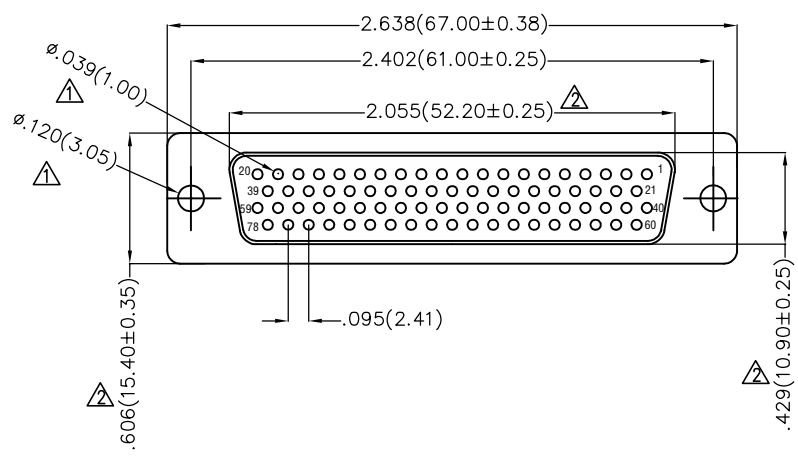
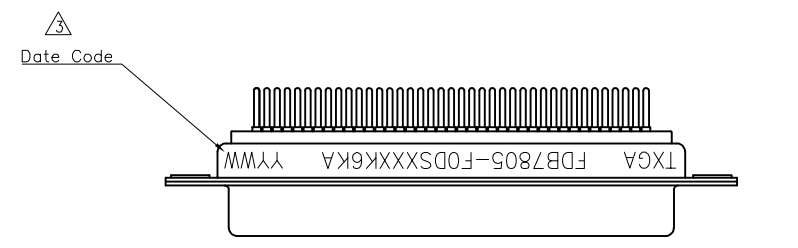

Recommended P.C.Board Layout

REV	LOCATIONS	DESCRIPTION	DATE	REVISER	APPD
1	△	ADD DIM	13/AUG/15	KEVIN	CHERRY
2	△	Add marking code	13/Jan/25	NICK	LEO
3	△	Update dimensions	10/JUN/25	MATT	LEO

SPECIFICATIONS

Electrical

Current Rating: 3A AC(rms)/DC
Voltage Rating: 250V AC(rms)/DC
Contact Resistance: 30 mΩ Max
Insulation Resistance: 1000 MΩ Min
Withstanding Voltage: 500V AC r.m.s
Temperature Range-Operating: -55°C~+105°C

Material and plating

Housing: PBT UL 94V-0
Contact: Copper Alloy/ Gold plated/
Selective gold in contact area, tin on tail
Shell: SPCC/ Nickel Plated
Nuts: Copper Alloy/ Nickel Plated

Ordering Information

FDB 78 05 - F0 D S X XX K6 K B
1 2 3 4 5 6 7 8 9 10 11

1	Category	2	Circuits	3	Distinction No.	4	Type	5	Assembly Layout	6	Entry Angle
	FDB- D-SUB Connector		78-78 Circuits		05		F0-Female		D-DIP		S-180° Vertical
7	Plating	8	Thickness of Plating	9	Color-Resin	10	Packaging	11	Distinction Type		
	1-Gold Plated 3-Selective gold in contact area, tin on tail		00-Gold Flash 03-3μ" Custom Plate Available		K6-Black		K-Tray		B-B Type		

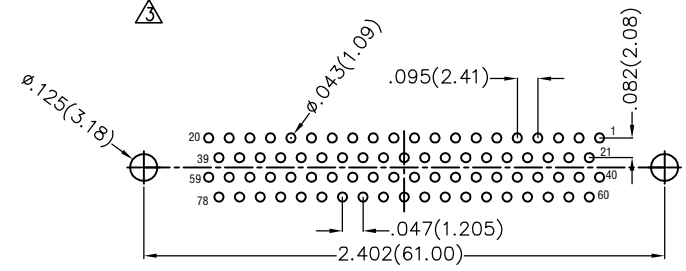
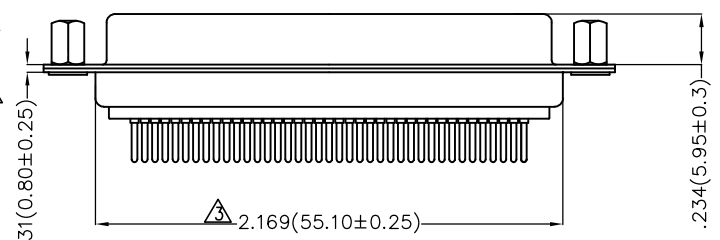
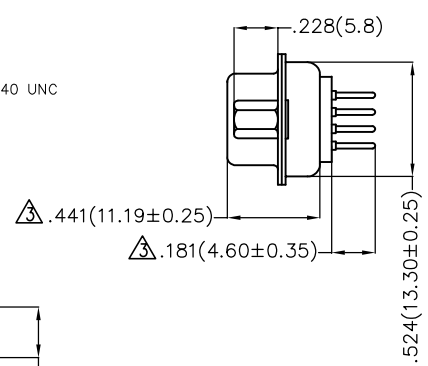
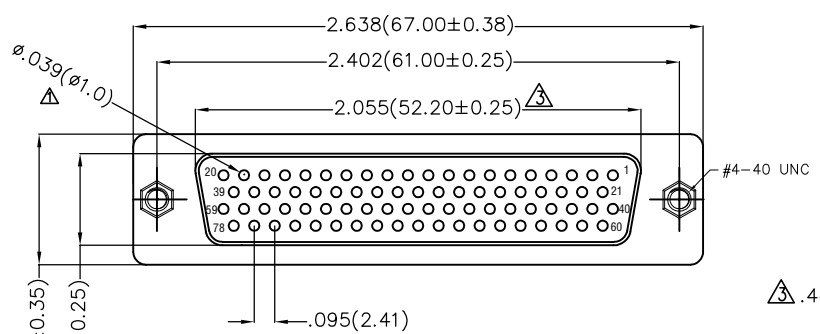
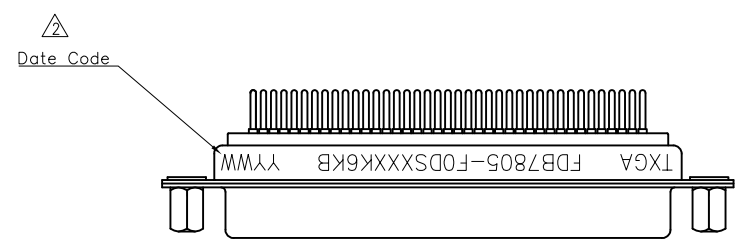

Recommended P.C.Board Layout

THIRD ANGLE PROJECTION	GENERAL TOLERANCES (UNLESS SPECIFIED)		APPROVE BY	DATE	PART NO.	ITEM NO.	
	X.±.012(0.30)	X'±5'	FRANK	28/AUG/13	FDB7805-F0DSXXXK6KB	FDB7805	
DESIGN UNITS Inch (metric)	X.X±.008(0.20)	.X'±2'	CHECKED BY	DATE	TITLE		Building Technology Cornerstone REV 3 SHEET NO. 1/1
	X.XX±.006(0.15)	.XX'±1'	CHERRY	28/AUG/13	D-SUB connector 78 Circuits 180° Vertical Female		
SCALE	SIZE	X.XXX±.004(0.10)	.XX'±0.5'	DRAWN BY	DATE	THIS DRAWING CONTAINS INFORMATION THAT IS PROPRIETARY TO TXGA INDUSTRIAL ELECTRONICS(S.Z)CO.,LTD AND SHOULD NOT BE USED WITHOUT WRITTEN PERMISSION	
5:1	A4			KEVIN	28/AUG/13		

REV	LOCATIONS	DESCRIPTION	DATE	REVISER	APPD
1		ADD DIM	13/AUG/15	KEVIN	CHERRY
2		Add marking code	13/Jan/25	NICK	LEO
3		Update dimensions	10/JUN/25	MATT	LEO

SPECIFICATIONS

Electrical

Current Rating: 3A AC(rms)/DC
Voltage Rating: 250V AC(rms)/DC
Contact Resistance: 30 mΩ Max
Insulation Resistance: 1000 MΩ Min
Withstanding Voltage: 500V AC r.m.s
Temperature Range—Operating: -55°C~+105°C

Material and plating

Housing: PBT UL 94V-0
Contact: Copper Alloy/ Gold plated/
Selective gold in contact area, tin on tail
Shell: SPCC/ Nickel Plated
Nuts: Copper Alloy/ Nickel Plated

Ordering Information

FDB 78 05 - F0 D S X XX K6 K C
1 2 3 4 5 6 7 8 9 10 11

1 Category FDB- D-SUB Connector	2 Circuits 78-78 Circuits	3 Distinction No. 05	4 Type F0-Female	5 Assembly Layout D-DIP	6 Entry Angle S-180° Vertical
7 Plating 1-Gold Plated 3-Selective gold in contact area, tin on tail	8 Thickness of Plating 00-Gold Flash 03-3μ" Custom Plate Available	9 Color-Resin K6-Black	10 Packaging K-Tray	11 Distinction Type C-C Type	

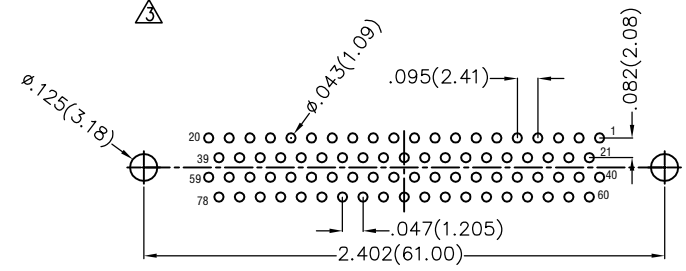
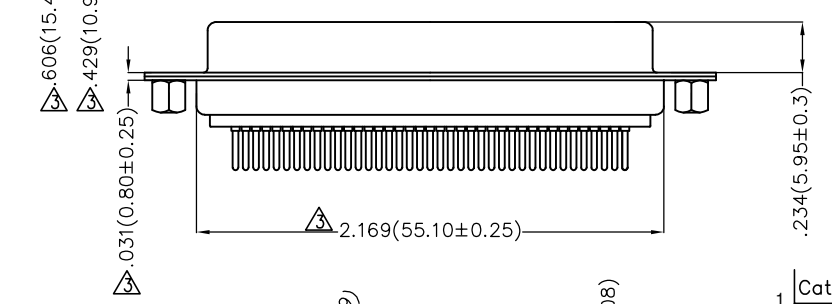
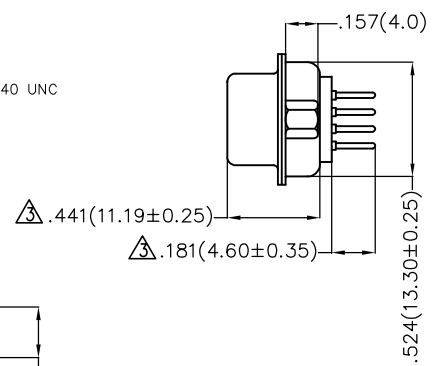
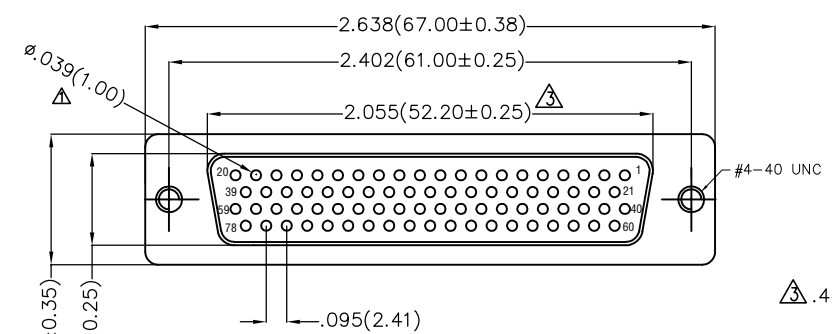
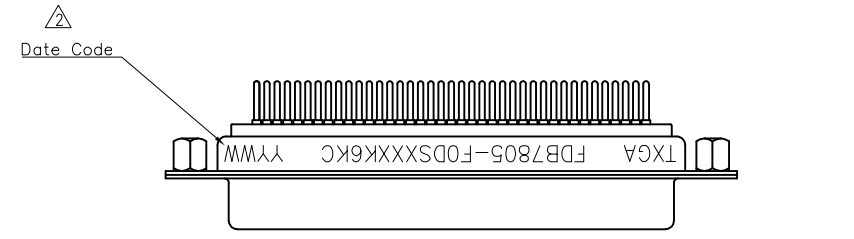

Recommended P.C.Board Layout

THIRD ANGLE PROJECTION	GENERAL TOLERANCES (UNLESS SPECIFIED)		APPROVE BY FRANK	DATE 28/AUG/13	PART NO. FDB7805-FODSXXXK6KC	ITEM NO. FDB7805	 Building Technology Cornerstone	
	DESIGN UNITS Inch (metric)	X.±0.12(0.30) X.X±.008(0.20) X.XX±.006(0.15) X.XXX±.004(0.10)	X'±5' .X'±2' .XX'±1' .XXX'±0.5'	CHECKED BY CHERRY	DATE 28/AUG/13	TITLE D-SUB connector 78 Circuits 180° Vertical Female		REV 3
SCALE 5:1	SIZE A4	DRAWN BY KEVIN		DATE 28/AUG/13	THIS DRAWING CONTAINS INFORMATION THAT IS PROPRIETARY TO TXGA INDUSTRIAL ELECTRONICS(S.Z)CO.,LTD AND SHOULD NOT BE USED WITHOUT WRITTEN PERMISSION			

REV	LOCATIONS	DESCRIPTION	DATE	REVISER	APPD
1	△	ADD DIM	13/AUG/15	KEVIN	CHERRY
2	△	Add marking code	13/Jan/25	NICK	LEO
3	△	Update dimensions	10/JUN/25	MATT	LEO

SPECIFICATIONS

Electrical

Current Rating: 3A AC(rms)/DC
Voltage Rating: 250V AC(rms)/DC
Contact Resistance: 30 mΩ Max
Insulation Resistance: 1000 MΩ Min
Withstanding Voltage: 500V AC r.m.s
Temperature Range—Operating: -55°C~+105°C

Material and plating

Housing: PBT UL 94V-0
Contact: Copper Alloy/ Gold plated/
Selective gold in contact area, tin on tail
Shell: SPCC/ Nickel Plated
Nuts: Copper Alloy/ Nickel Plated

Ordering Information

FDB 78 05 - F0 D S X XX K6 K D
1 2 3 4 5 6 7 8 9 10 11

1 Category FDB- D-SUB Connector	2 Circuits 78-78 Circuits	3 Distinction No. 05	4 Type F0-Female	5 Assembly Layout D-DIP	6 Entry Angle S-180° Vertical
7 Plating 1-Gold Plated 3-Selective gold in contact area, tin on tail	8 Thickness of Plating 00-Gold Flash 03-3μ" Custom Plate Available	9 Color-Resin K6-Black	10 Packaging K-Tray	11 Distinction Type D-D Type	

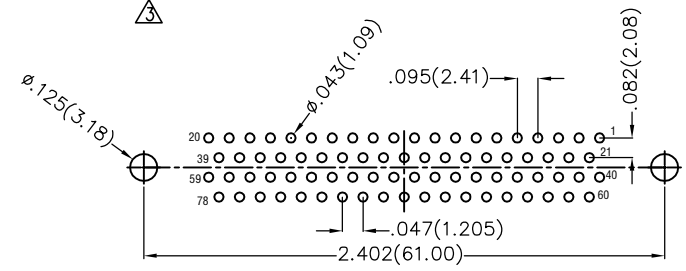
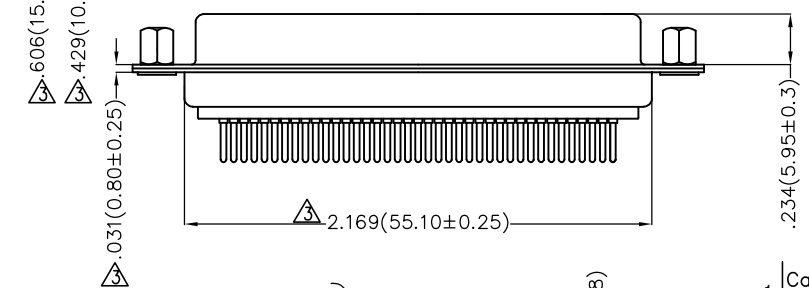
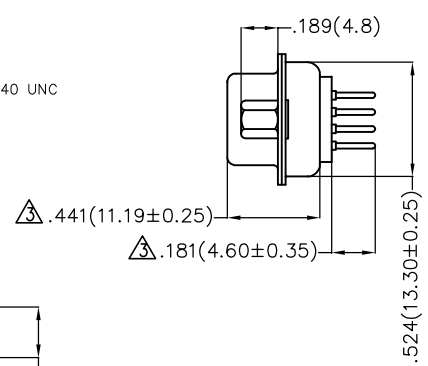
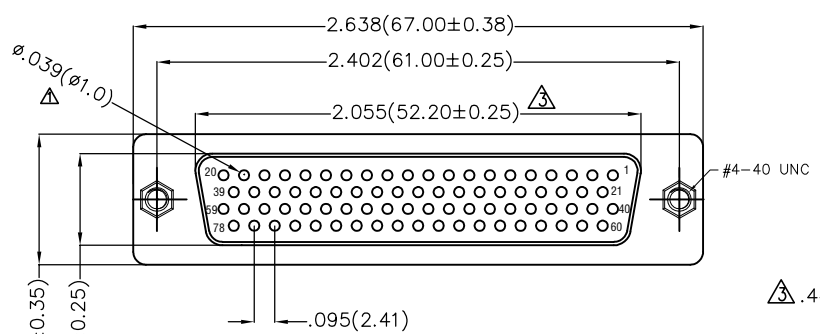
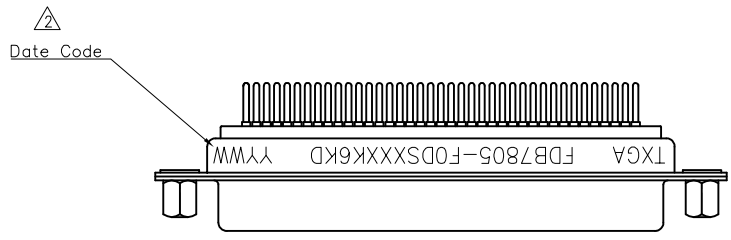

Recommended P.C.Board Layout

THIRD ANGLE PROJECTION	GENERAL TOLERANCES (UNLESS SPECIFIED)		APPROVE BY FRANK	DATE 28/AUG/13	PART NO. FDB7805-FODSXXXK6KD	ITEM NO. FDB7805	
	X.±.012(0.30)	X'±5'	CHECKED BY CHERRY	DATE 28/AUG/13	TITLE D-SUB connector 78 Circuits 180° Vertical Female		
DESIGN UNITS Inch (metric)	X.XX±.008(0.20)	.X'±2'	DRAWN BY KEVIN	DATE 28/AUG/13	THIS DRAWING CONTAINS INFORMATION THAT IS PROPRIETARY TO TXGA INDUSTRIAL ELECTRONICS(S.Z)CO.,LTD AND SHOULD NOT BE USED WITHOUT WRITTEN PERMISSION		
SCALE 5:1	SIZE A4	X.XX±.006(0.15)	.XX'±1'				
		X.XXX±.004(0.10)	.XX'±0.5'				

REV	LOCATIONS	DESCRIPTION	DATE	REVISER	APPD
1	△	ADD DIM	13/AUG/15	KEVIN	CHERRY
2	△	Add marking code	13/Jan/25	NICK	LEO
3	△	Update dimensions	10/JUN/25	MATT	LEO

SPECIFICATIONS

Electrical

Current Rating: 3A AC(rms)/DC
Voltage Rating: 250V AC(rms)/DC
Contact Resistance: 30 mΩ Max
Insulation Resistance: 1000 MΩ Min
Withstanding Voltage: 500V AC r.m.s
Temperature Range-Operating: -55°C~+105°C

Material and plating

Housing: PBT UL 94V-0
Contact: Copper Alloy/ Gold plated/
Selective gold in contact area, tin on tail
Shell: SPCC/ Nickel Plated
Nuts: Copper Alloy/ Nickel Plated

Ordering Information

FDB 78 05 - F0 D S X XX K6 K E
1 2 3 4 5 6 7 8 9 10 11

1	Category	2	Circuits	3	Distinction No.	4	Type	5	Assembly Layout	6	Entry Angle
	FDB- D-SUB Connector		78-78 Circuits		05		F0-Female		D-DIP		S-180° Vertical
7	Plating	8	Thickness of Plating	9	Color-Resin	10	Packaging	11	Distinction Type		
	1-Gold Plated 3-Selective gold in contact area, tin on tail		00-Gold Flash 03-3μ" Custom Plate Available		K6-Black		K-Tray		E-E Type		

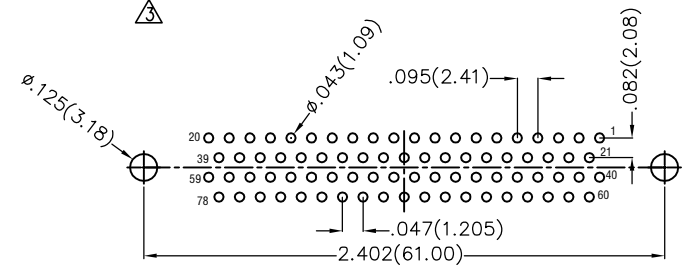
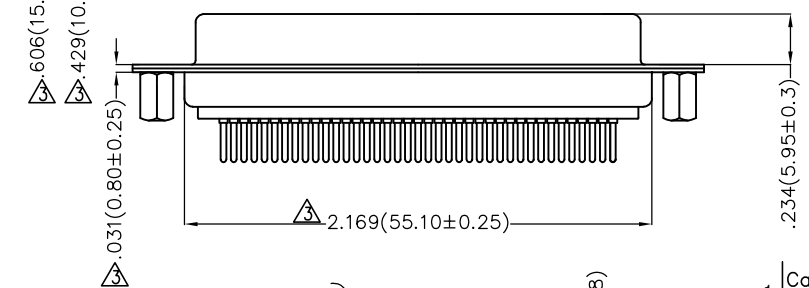
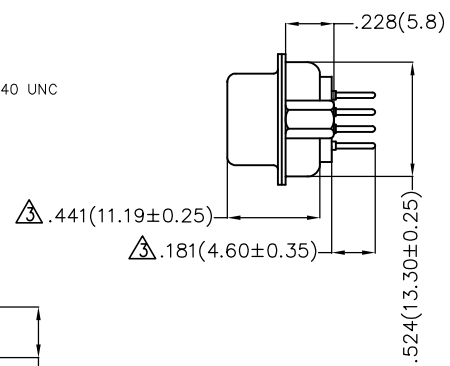
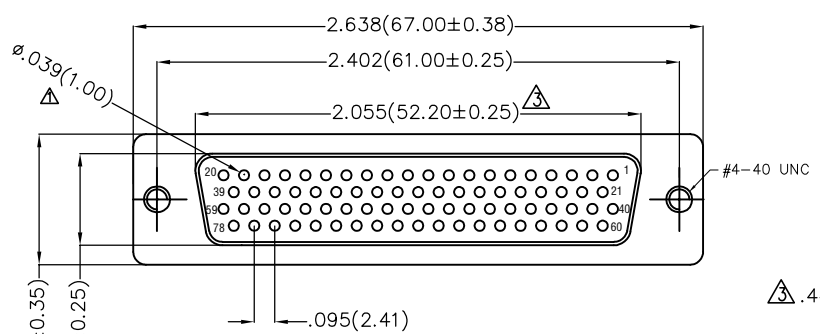
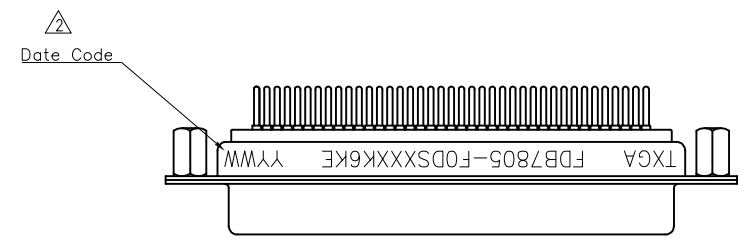

Recommended P.C.Board Layout

THIRD ANGLE PROJECTION	GENERAL TOLERANCES (UNLESS SPECIFIED)		APPROVE BY	DATE	PART NO.	ITEM NO.	
	X.±.012(0.30)	X:±5'	FRANK	28/AUG/13	FDB7805-FODSXXXK6KE	FDB7805	
DESIGN UNITS Inch (metric)	X.X±.008(0.20)	.X'±2'	CHECKED BY	DATE	TITLE	Building Technology Cornerstone	
SCALE	X.XX±.006(0.15)	.XX'±1'	CHERRY	28/AUG/13	D-SUB connector 78 Circuits 180° Vertical Female	REV 3	SHEET NO. 1/1
SIZE	X.XXX±.004(0.10)	.XXX'±0.5'	DRAWN BY	DATE	THIS DRAWING CONTAINS INFORMATION THAT IS PROPRIETARY TO TXGA INDUSTRIAL ELECTRONICS(S.Z)CO.,LTD AND SHOULD NOT BE USED WITHOUT WRITTEN PERMISSION		
5:1			KEVIN	28/AUG/13			

REV	LOCATIONS	DESCRIPTION	DATE	REVISER	APPD
1	△	ADD DIM	13/AUG/15	KEVIN	CHERRY
2	△	Add marking code	13/Jan/25	NICK	LEO
3	△	Update dimensions	10/JUN/25	MATT	LEO

SPECIFICATIONS

Electrical

Current Rating: 3A AC(rms)/DC
Voltage Rating: 250V AC(rms)/DC
Contact Resistance: 30 mΩ Max
Insulation Resistance: 1000 MΩ Min
Withstanding Voltage: 500V AC r.m.s
Temperature Range-Operating: -55°C~+105°C

Material and plating

Housing: PBT UL 94V-0
Contact: Copper Alloy/ Gold plated/
Selective gold in contact area, tin on tail
Shell: SPCC/ Nickel Plated
Board Lock: Copper Alloy/ Tin Plated
Screws: Copper Alloy/ Nickel Plated

Ordering Information

FDB 78 05 - F0 D S X XX K6 K F
1 2 3 4 5 6 7 8 9 10 11

1	Category FDB- D-SUB Connector	2	Circuits 78-78 Circuits	3	Distinction No. 05	4	Type F0-Female	5	Assembly Layout D-DIP	6	Entry Angle S-180° Vertical
7	Plating 1-Gold Plated 3-Selective gold in contact area, tin on tail	8	Thickness of Plating 00-Gold Flash 03-3μ" Custom Plate Available	9	Color-Resin K6-Black	10	Packaging K-Tray	11	Distinction Type F-F Type		

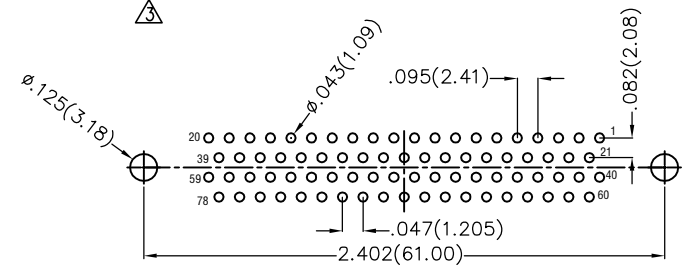
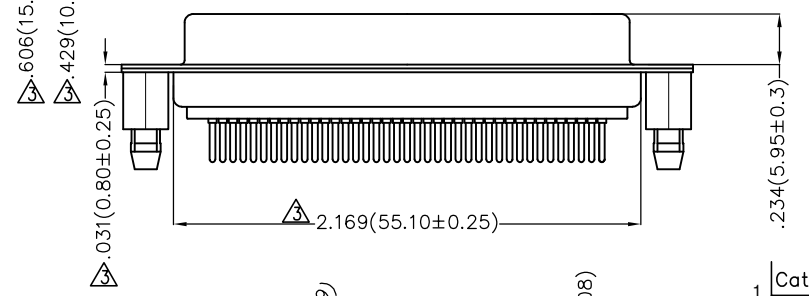
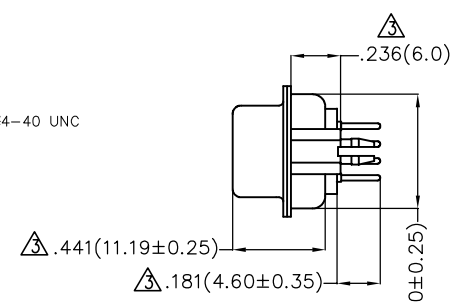
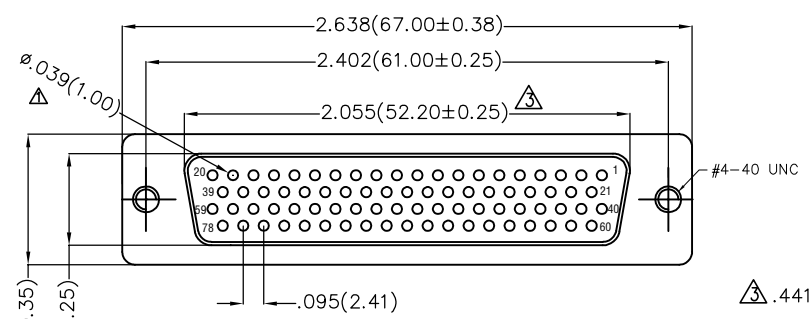
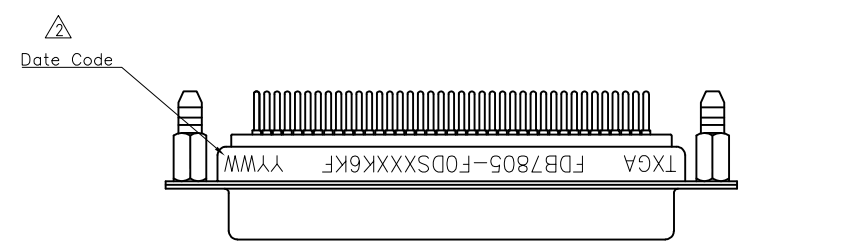

Recommended P.C.Board Layout

THIRD ANGLE PROJECTION	GENERAL TOLERANCES (UNLESS SPECIFIED)		APPROVE BY FRANK	DATE 28/AUG/13	PART NO. FDB7805-FODSXXXK6KF	ITEM NO. FDB7805	 Building Technology Cornerstone
	X.±.012(0.30)	X'±5'	CHECKED BY CHERRY	DATE 28/AUG/13	TITLE D-SUB connector 78 Circuits 180° Vertical Female		
DESIGN UNITS Inch (metric)	X.X±.008(0.20)	.X'±2'	DRAWN BY KEVIN	DATE 28/AUG/13	THIS DRAWING CONTAINS INFORMATION THAT IS PROPRIETARY TO TXGA INDUSTRIAL ELECTRONICS(S.Z)CO.,LTD AND SHOULD NOT BE USED WITHOUT WRITTEN PERMISSION		REV 3
SCALE 5:1	SIZE A4	X.XX±.006(0.15)					SHEET NO. 1/1
		X.XXX±.004(0.10)					